



3 Bedrooms, 2 Baths
1,207 Living Area
34'4" x 42'8" Dimensions



A magnificent kitchen/dining room combination highlights The Poplar. The optional bump-out window enhances the home's appeal. Three bedrooms and two full baths complete the design of this Ranch home.

*Top elevation shown with optional bump-out window with metal roof, as well as on-site completed porch.



828.274.4699
info@draliving.com
www.draliving.com

The Poplar

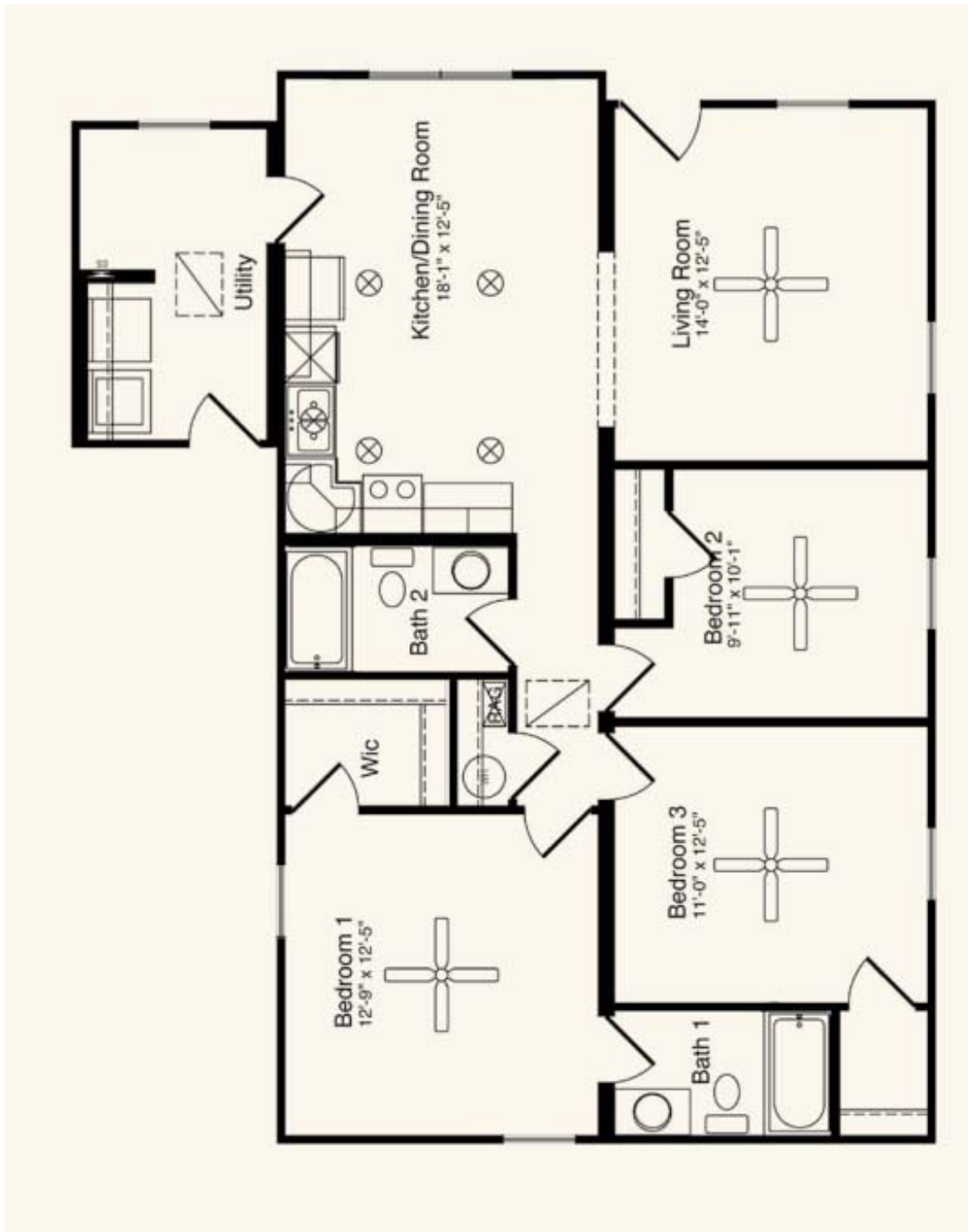

828.274.4699
info@draliving.com
www.draliving.com

The Poplar