



3 Bedrooms, 2.5 Baths  
1,994 1st Floor, 663 2nd Floor,  
2,657 Living Area  
32' x 64' Dimensions



Inspired by the low country areas of the South, this plan offers spacious living in grandiose style. An open foyer and living room with the stair balcony overlooking both areas. The master bedroom, living room, breakfast nook and kitchen areas are situated at the rear of the home with lots of glass to capture those scenic panoramas of water or wilderness.

\*Elevation shown with optional oval windows, transoms above front windows, sidelites at front door, elliptical transom above front door, on-site constructed front and rear porches. Bluffton III floorplan is 2,517 sq. ft.



828.274.4699  
info@draliving.com  
www.draliving.com

# The Bluffton

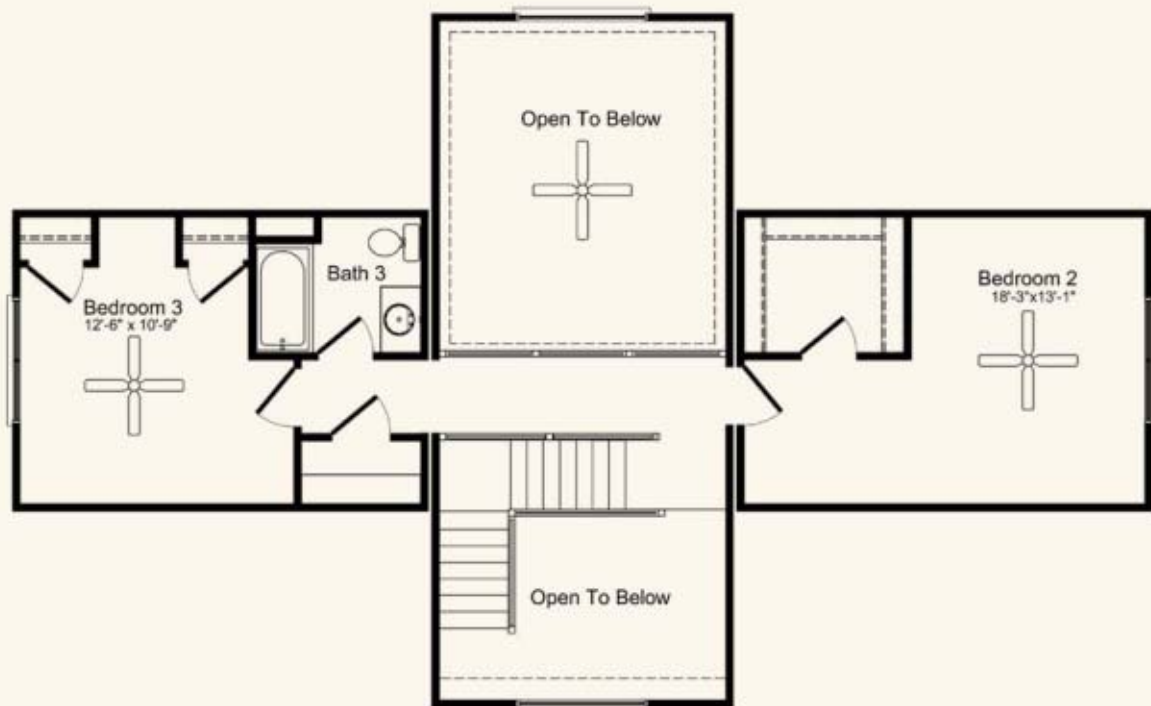

828.274.4699  
[info@draliving.com](mailto:info@draliving.com)  
[www.draliving.com](http://www.draliving.com)

# The Bluffton